



## Christmas Preparations

**“And Mary said, ‘Behold, the bondslave of the Lord; may it be done to me according to your word.’”**

Luke 1:38

Christmas is my favorite time of the year. I enjoy driving through the winter night in a warm car with my family admiring houses decorated with bright lights and nativity scenes. I love the delicious home cooked food and seeing relatives at my parents’ house in Torrance on Christmas Eve. Or gathering my family in front of our Christmas tree Christmas morning to share about the birth of our Lord Jesus Christ before Trent opens his gifts.

Yet without adequate preparation and willing sacrifice, none of these wonderful traditions would be enjoyed during Christmas. It takes a lot of time preparing for meals, cooking, and running around the house cleaning up. A great deal of thought and energy goes into driving through filled parking lots at crowded malls to find the perfect gift for a friend. This year I finished setting up my house Christmas lights outside drenched in a heavy downpour. And it takes effort amidst the holiday busyness of shopping, gift wrapping, and washing dishes after parties to slow down and worship Jesus Christ which is the point of Christmas. So it is through our inconveniences and sacrifices that others are blessed and Jesus Christ is glorified during Christmas.



Pastor Kyle Shimazaki with Carolyn, Trent and baby Faith.

There is no greater example of this than Mary’s own personal surrender to the Lord. An angel brought great news of her miraculous pregnancy and that her baby would be called **the Son of God who’s kingdom would have no end**. Mary counted the cost of possibly being divorced by Joseph whom she loved and was betrothed, being shamed out of society, judged as an adulterer, and being left alone to raise her child. Yet in her heart Mary was convinced it was worth it to surrender all as a **bondslave of the Lord** in order to be favored by God. By faith she willingly yielded her life to God declaring, **“May it be done to me according to your word.”** Mary’s desire to obey God led to the inaugural Christmas of Christ’s birth which blesses us today.

What have you sacrificed this holiday in order to bring Christ into the center of your Christmas? You may need to ask forgiveness from someone you offended or are angry with, or possibly breaking off an unhealthy relationship. Maybe God is leading you to pray for someone, or asking you to

make a greater commitment to the building fund, or to spend more time with your children and raise them in the Lord. Yet to surrender your life as Mary did often is fearful or may cause you to wonder if it is worth it. It is important to know that the safest place you can be in surrendering all to Christ for it leads to the perfect will of God and true satisfaction. Remember He came to Earth for you and gave you a life worth living.

Merry Christmas—Christ is born!

*Kyle Shimazaki*

### *A look inside:*

Home Page	2
Site News	3
Devoted to Him	4
Life’s Moments	4
Congregational Life	5
Explorer Interview	5
Worship Council	6
Outreach	7
Our Greater Community	8

### Staff

Senior Pastor  
Cory Ishida

### Associate Pastoral Staff

George Egami  
Seniors Ministries

Rev. Jan Arthur Lee  
Congregational Life Ministries

Ron Miyake  
Prayer Ministries

Raynold Nakamura  
Community Outreach Ministries

Adam Noritake  
Administration Ministries

Kyle Shimazaki  
Outreach Ministries

### Assistant Pastoral Staff

Dan Christian

Outreach & Congregational Life  
Ministries

Jojo Ma

Congregational Life Ministries

Paul Moy

Youth Ministries

Ian Nagata

Worship Ministries

### Ministry Associates

Katie Wong

Director of Children’s Ministries

Sunday Asaoka (pt)

Children’s Ministries

Kay Carey (pt)

Outreach Ministries

Sanjung Chiu (pt)

Music Director

Wendy Liu (pt)

Children’s Ministries

Carly Yoshitani (pt)

Children’s Ministries

### Interns

Victor Chen (pt)

Ira Chui (pt)

Daniel Eng (pt)

Darryl Jung (pt)

Ronald Sarayudej (pt)

Matt Tsushima (pt)

### Administrative Staff

Helen Der

Admin. Asst., OnLine Editor

Gerry Morita (pt)

Accountant

Joyce Salgado

Office Asst., Editorial Asst.

Carey Yung

Facilities Maintenance Supervisor

# Home Page

## Christmas Eve

Christmas Eve Service will be held on Monday, Dec. 24 at 9 pm (please note the time). Come share the majesty of *Agnus Dei (Lamb of God)* as we celebrate the birth of Jesus Christ. The traditional candlelighting is a highlight of the evening (it may be outdoors this year!)

## OnLine is on the web!

The OnLine is now online! Visit the webpage [www.evergreensgv.org](http://www.evergreensgv.org) and click under Archives. For those of you who prefer receive each new edition via email, you can sign up by contacting the office at [info@evergreensgv.org](mailto:info@evergreensgv.org). Please inform us if you wish to be removed from the snail mail list.

Did you know you can access past sermons at the Archives? You can listen to it or save it for another time. Check it out!

## Wedding Blessings

Congratulations to *Lawrence Tan* and *Alice Yang* who were married by *Pastor Cory* on Dec. 2. Vows were exchanged in a private ceremony here at Evergreen SGV.

## It's a Boy

*Traci and Gary Higa* were blessed by the birth of their son, *Scot Matthew* on Nov. 27, weighing 6 lb 10.5 oz, 19.5 inches long. Big sister is *Natalie*, and grandparents are *Kenji and Pat Tanimoto*.

## In Remembrance

Our condolences to *Jeffrey & Kim Lee* on the recent passing of *Jeffrey's* father, *Walter*.

Our sympathies to the family of *Jack Masumoto*, a longtime member of Evergreen who passed away on Nov. 30. *Jack's* wife of 67 years, *Terry* passed away earlier this year.

## Coffee Hour Needs Help

How can you host a gathering of over 100 people without worrying about the state of your home? By serving on Sundays through the Coffee Hour Ministry! Most volunteers (some are families) serve once a month. To find out more, please contact *Kenny Nishida* through the church office.

## Nametags

Need a nametag? Sign up for one at the Open House. Let's help out those people who can't remember names! Have **you** met anyone new in the last week? Pick up your requested nametag at the Office Table.

## Wanted: Sunday Driver

Do you live in the Monterey Park area? Do you have room in your car for another passenger? Do you attend 8 am service? We need a driver to provide rides for a congregant who lives in Monterey Park, east of Monterey Pass Road and north of East Los Angeles College.

If interested in participating in this ministry, please contact *Clare Kodama* through the church office.

## Reimbursement Requests

The 2007 accounting books will be closed by Dec. 31. All final check requests that will be processed for the 2007 budget must be in before the end of the year. They may be turned in to the Office no later than Thursday, Dec. 27 for timely processing.

## Year-end Offering

As 2007 draws to a close, please make sure all offerings you wish to be credited for 2007 are received at church on Sunday, Dec. 30, or post-marked by Monday, Dec. 31.

If you have moved, or if you use checks with business/outdated addresses, please check with the church office so your giving record will be sent to the correct address. A call from you now will prevent needless worry!

## Event Calendar

### December

- 13 Thu glo Young Adult Ministry
- 14 Fri Youth Ministries
- 15 Sat NO Harvesters Seniors Group  
*College Ministry*
- 16 3<sup>rd</sup> Sunday of Advent Worship Svcs  
*Staff, Otoshidama Offering*  
Church School Christmas Program  
*Prayer Ministry*
- 20 Thu glo Young Adult Ministry
- 21 Fri No Surge, but Bridge meets
- 22 Sat College Ministry
- 23 Sun Christmas Worship Service  
*Christmas Offering*  
*Otoshidama Offering*  
*Prayer Ministry*
- 24 Mon Christmas Eve Service 9:00 pm
- 24-26 Office closed
- 27 Thu glo Young Adult Ministry
- 28 Fri No Youth Ministries
- 29 Sat College Ministry
- 30 Sun Worship Services  
*Prayer Ministry*

### January 2008

- 1 Tue New Year's Day  
Church Office closed
- 3 Thu No glo Young Adult Ministry
- 4 Fri No Youth Ministries  
Board Meeting
- 5 Sat College Ministry
- 6 Sun Worship Services  
*Communion*  
*Fellowship Offering*  
*Prayer of Blessing*  
*Adult Church School Begins*  
*Prayer Ministry*
- 8 Tue Harvester's Bible Study  
Trustees Meeting  
MIB Men in the Bible
- 10 Thu glo Young Adult Ministry
- 11 Fri Youth Ministries
- 11-13 Board Retreat
- 12 Sat Keiro Services  
College Ministry
- 13 Sun Worship Services  
ACS begins  
*Prayer Ministry*

# Property Acquisition & Architectural Transition Team Update 3.9

"It Is finished."

Not even. Only sort of.

On the first Sunday of December, we celebrated worship for the first time with Church School in our new classrooms. Never mind that two of the largest rooms won't be ready for another week or so, or that the tables and desks will arrive later. *Katie Wong* and her staff did a marvelous job of coordinating the move into the classrooms, purchasing furniture, assembling toys and organizing supplies. She did this during the rain that made it necessary to constantly wipe your feet to keep the new vinyl floors and rugs from getting soiled.

And speaking of the rain, *Wai Quock* and *Jerry Mar* are geniuses. *Wai*, because he devised a plan of diverting 90% of the rain water from the West Wing and the westerly portion of the parking lot into the storm drain off of Coberta. So instead of a five foot raging torrent of water in front of the Sanctuary, there was a 12 inch trickle, even during the dampest part of the storm. *Jerry*, because he regraded the south lawn to drain water onto the emergency access road, dug a huge gravel drain in front of the Multi Purpose Room (MPR), and with *Wai's* help, recemented the area between the Sanctuary and the MPR to efficiently drain water away from and NOT INTO the previously mentioned buildings. We are presently installing an additional collection box to this area.

So now, as our goal of fully moving in is another step closer, here are a few thoughts. It seems that I have always been more PROCESS oriented during my life, as opposed to the more male, GOAL oriented. I have totally enjoyed the path that God has led us on the past few years, including the purchase of Maple Leaf Park, the legal entanglements we have undergone, the sale of Maple Leaf, the purchase of Victory Outreach, and now, the work of moving onto our new site.

In showcasing where we are now,

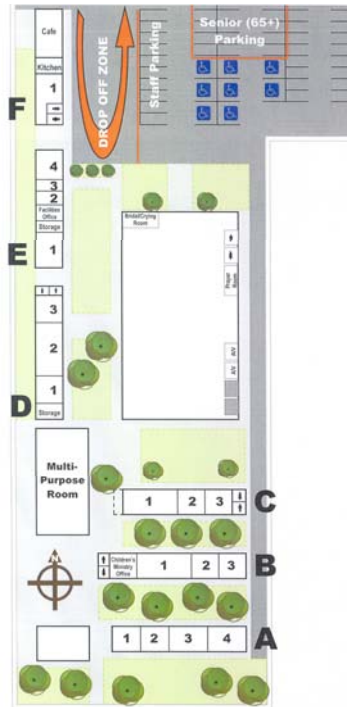

unfortunately, we have had to obliterate where we have been regarding the original condition of the property when we first purchased it. I am quick to remind staff and church members when they complained of the obvious defects everywhere they looked, that we purchased this property AS IS. So it is all but impossible to compare and contrast the property improvements as well as fully appreciate the tremendous amount of skill, hard work, planning, execution, thoughtfulness, inspiration, cooperation, sacrifice, perseverance, ingenuity, and creativity that was poured into all that we did by all that were involved, to get this property ready to occupy.

Our next big task before the predicted weekend rain is to prepare the MPR for our annual Christmas Potluck, as well as for a funeral reception for one of our longtime members. Rain continues to be a big problem on site and the last storm necessitated that we replace the east half of the B bldg roof, as well as resurface/rebuild one portion of the entrance roadway into the main parking lot near the Quonset Hut area.

Also on tap are the following:

-complete all work on classrooms B1,

B2/B3 and C1/C2.

-demolish the C building Visitor Information Center counter and B building stand alone sign.

-complete lighting work in all classrooms.

-complete repairs to Sanctuary doors.

-repair exterior lighting on classroom buildings.

-repair and install Café ceiling/lighting.

-continue repairs to 335 Workman Mill house.

-install basketball posts and backboards to Quonset Hut area courts as well as lighting saved from Maple Leaf Park.

-slurry coat and restripe the parking lot according to the final Master Plan specifications.

Enjoying the process, the journey, the time spent traveling from purchase to move in has allowed me to more fully appreciate the blessing of God's grace, physical presence, power, sovereignty and love than if I had only focused on the end product, the goal. But for those others of you who do look towards the finish as the most important, you remind of *Ruth Graham*, the wife of *Billy Graham*. She recently passed away and went home to be with the Lord, Before she died, she instructed that these last words be etched onto her marker stone over her grave: "End of Construction. Thank you for your patience."



*Steven Ogata*

Building Project Administrator

Oh yes, I almost forgot. A brief financial accounting will be forthcoming early next year as soon as all the figures come in from the various subcontractors and vendors, and after all the rest of the necessary work is completed that will allow us to move in fully and use this grand facility to its utmost for His highest.

## *Life's Moments: "Respect" by Helen Der*

Things that weren't an issue at Rio Hondo or at the former church office have created challenges...hence this gentle reminder.

**R** Reverence: this is God's house; we should take good care of it.

**E** Evergreen, of course! To be green; let's carpool more and recycle our bottles and cans instead of trashing them.

**S** Stewardship: How best to use what God has given us? It's a both a privilege and responsibility for each of us.

**P** Places. If you borrow something, even with permission, return it to the right place! You can imagine what a job it is keeping track of tables and chairs that get moved for each meeting. Let's also recognize that some places are off limits: personal office space, the stage, sound room. Parents, do you know where your children are?

**E** Energy (see next item)

**C** Conservation-- we need to conserve when we can, and turn lights off and keep doors shut when possible. Please note: there are certain motion sensors (Women's restroom) and timers that don't need to be shut off, thank you! Which brings us to...

**T** Thankfulness that our heavenly Father provides for us abundantly.

P.S. If you borrowed the tape dispensers, extension cords and/or box cutters, I'd appreciate having them back.

## *Devoted to Him: "Study in Contrasts" by Ron Nakamura*

*"Study in contrasts and think of examples, you will have no problems in biology class."*

My high school biology teacher taught me this concept many years ago. I have found this maxim useful in other areas as well. During Thanksgiving 2004, I spent the holiday with my sister in Northern California. At the time, I was having trouble sleeping, experiencing labored breathing and feeling chronically tired. That was the precursor to my being hospitalized in January 2005 and ultimately undergoing open heart surgery in February.

In contrast, it was much more pleasant to celebrate Thanksgiving this year, as I made the turkey and some of the fixings for my wife *Janis'* family dinner. Another contrast involves Kaiser Permanente (my employer) implementing an electronic health record, which includes patient scheduling. I spent 3 days in the cardiac surgery department, helping them get familiar with this application. I specifically chose this department because I was so grateful to them for the care I received.

I had the opportunity to see the surgeon who performed my surgery, and I asked him if he remembered me. He

replied "Of course I do. Show me the top of your scar!" I spent time with the scheduler who made my surgical appointment and told her she was my guardian angel. You see, on the night I signed some estate planning documents in preparation for surgery, I had some men from the branch praying for the scheduling of my procedure, because we were waiting for the surgeon to return from vacation. As the men were praying, the answering machine went off, and I could hear a voice in the background; "Hi, this is Cathy from the cardiac surgery department and I am calling to schedule your surgery..."

At the Thanksgiving eve service, I was struck by the individuals who shared stories of giving thanks amidst times of tragedy, sorrow and grief. The examples I shared above remind me of God's faithfulness both in times of hardship and during good times. Often times, it is difficult to see how far God has brought us until you look back.

*Give thanks to the LORD, for  
he is good; his love endures  
forever.  
Psalm 118:1*



*The Nakamuras: Janis, Jenni, Reine and Ron*

## Congregational Life "Grow"

### Surge (Junior High)

Fri., 7:30 pm, Church Lobby.

**Dec. 14:** *Daniel Eng* will be our guest speaker.

**Dec. 21:** It's our Christmas Event! Details have not been finalized, so stay posted on our blog, [www.surgejrhigh.blogspot.com](http://www.surgejrhigh.blogspot.com)

**Dec. 28:** No meeting.



Call *Matt Tsushima* (right) at 626 363-0300

### The Bridge (High School)

Fri., 7:30 pm, Church Sanctuary.

**Dec. 14:** Christmas Party!

**Dec. 21:** Christmas activity! Join in!

**Dec. 28:** No meeting

**NOTE:** Retreat dates: 1/25-27.

For info., call *Paul Moy* (right) at 626 363-0300.



### Living Stones (College Age)

Sat., 6:30 pm, Intern's House. 319 Workman Mill Rd., La Puente

**Dec. 15:** Meeting!

**Dec. 22:** to be announced

**Dec. 29:** to be announced

Check out the website, [www.abidingic.net!](http://www.abidingic.net!)  
Call *Ira Chui* at 626 363-0300.



### glo Young Adult Group

Thursday, 7:30 pm, Café.

**Dec. 13:** *Dan* will teach on 1 John 5:13-15

**Dec. 20:** *Chris* will lead our group on 1 John 5:16-17

**Dec. 27:** No meeting

**Jan. 3:** No meeting

For info., call *Victor Chen*, (pictured above) 626-363-0300.



### Harvesters - Seniors

We meet on the 3rd Saturday of each month, 8:30 am, Café.

Our next meeting will be our special Japanese New Year's luncheon. We will meet for lunch. Our guest speaker will be *Pastor Cory Ishida* who will help us usher in 2008.

The Harvesters' Bible study is on break until 2008. For info., call *Pastor George Egami* at 626 363-0300.



## Just Exploring: An Interview with Carey Yung

We've asked Carey Yung, our newest staff member to share about himself. Carey and his wife Patti (at right) are familiar faces on Sundays and at Prayer Ministry events.

I became a Christian on August 4, 1985 at a Sunday morning communion service at 2<sup>nd</sup> & Evergreen in Boyle Heights. A friend brought me to Evergreen early that year, and through a 7-month questioning period, I started my journey to search out "Who is this God?" and to understand what a Christian is all about. Even though I discovered I had friends that attended this church (from school & basketball), there was more to it. It was about choosing a relationship with Him that was very personal and that was about Him alone for my life. After months of questions and spending time talking with friends (and pastors) about Christianity, there was finally peace and understanding of who He was. I was ready on that communion Sunday to walk with Him.



I currently serve on staff as the Facilities Maintenance Supervisor. I also serve on the Trustee Board, Property Acquisition & Architectural Transition Team (PAATT), Prayer Ministry, and China Outreach Ministry.

#### Working...

I've been doing plumbing for 33 years (yes, I'm really that old!). For the last 21 years, I've been a plumbing contractor and have my own business, Precise Plumbing.

#### Pastimes...

I enjoy spending time with my wife, my family and my friends – just hanging out! I enjoy fly-fishing at least once a year, more if time permits. And since I've retired from basketball,

I enjoy watching my nephews and friend's kids play ball.

#### Family matters...

My wife is *Patti* and we just celebrated our 6<sup>th</sup> anniversary on December 1. Both sides of our extended family are very large, with *Patti's* Mom & Dad, a total of 4 siblings each and a grand total of 15 nephews and nieces (ranging from infant to young adult age) and one baby grandniece.

#### Challenges/blessings experienced on the job...

The challenge is being ready for the plan that God has for us in our new community with this new land.

The blessing is seeing His provision through the workers, volunteers and vendors every day. The blessing is the simple thanks through words, care and meals given to our staff and me during this significant time in preparing our new church home.

## Worship Council

The Worship Council and their families recently gathered at the *BChang (Bryan & Bethany Chang, along with daughters Brooklyn & Bailey)* home to celebrate *Pastor Ian's* birthday. A "blazing" time was had by all, especially when the birthday candles collapsed and started a mini bonfire on the cake. It was a wonderful time of breaking bread together, catching up and enjoying the precious gift of friendship. Praise the Lord for fellowship and serving alongside great friends!



Above, Pastor Ian tests the temperature of his cake with the collapsing candles, as delighted children look on.

Left, Worship council members Bethany Chang, Craig Kakihara and Kevin Yeh congratulate Pastor Ian.



## Should I See Movies Like "The Golden Compass"?

The Evergreen OnLine has no resident film critic and this author doesn't claim to be one. Like most of you, I enjoy a good movie now and then, but sometimes the most discernment I use in whether or not to see a movie is based on whether it will be worth the \$10.00 to see it (or more realistically the cost of planning an entire "date night" with my wife at an estimated cost of \$80.00-100.00 total for two tickets, childcare, dinner and parking). When seen in this light, most movies are ruled out simply as not being worth it (but my wife is always worth it!).

But let's suppose you're not a boring middle-aged family man with time to spare and extra funds to use. How do you usually decide which movie to see? What factors play into seeing one movie as opposed to another? Our church could probably set out some guidelines for you about seeing movies, but my hope is that each of you would develop an "inner compass" called discernment.

The Bible speaks of wisdom and discernment as two of the best qualities to develop in our lives. When a young King Solomon took up the throne of Israel after his father David, his prayer to the Lord was for a discerning heart to govern the Lord's people and the ability to distinguish between right and wrong (1 Kings 3:9). And the very next verse tells us that the Lord was pleased with Solomon's request and granted it to him. My hope is that you as well would request this from the Lord. I trust that he will be faithful to honor such a petition.

Thankfully, we also have the gift of the Holy Spirit to speak, guide and direct us in matters involving not only which movies to watch, but also in navigating through choices of careers, relationships, how to use time and fulfilling our respective calling from the Lord. As Christians, the Holy Spirit dwells within us and serves as a friend, guide, and revealer of God's truth. The Spirit, however, battles with our flesh and sin usually occurs when

we disregard the Spirit and give in to the flesh. My personal desire for my life and for all of you is that we would allow our lives to be conquered, led and directed by God's Holy Spirit within us.

But getting back to choosing a good movie...Should Christians watch a movie like *The Golden Compass*? Rather than give you a 'yes' or 'no' answer, ask God instead. Then read some reviews on the web and check out [Christianitytoday.com](http://Christianitytoday.com) under their culture and media tab for access to honest and critical reviews of movies like *The Golden Compass*. Apparently, the movie is based on a trilogy written by an atheist named *Phillip Pullman* who has publicly expressed disdain for Christianity. In it, one of the protagonists is joined by others who seek to kill God and the Christian faith - sounds menacing to me. But this theme is veiled within the trilogy and one may need to look closer to discern these themes running through them. (continued on pg. 7)

## *“Building Bridges” by Pastor Jon Hori*

Since the inception of Lifesong, small groups have been a foundational part of the way that we do ministry.

Our small groups are called “Bridge Groups” because we envision them to be expressions of the Kingdom that build “bridges” with God, with one another and with the surrounding community.

This past session (Sept.-Dec.), we had nearly 90% of our church family participate in seven different Bridges. The focus of the study was on our Sunday morning sermon series titled, “Shine,” (Matt. 5:16). The series was designed to equip and encourage our church family to share the good news of Jesus in both word and deed. Each group not only studied what the Bible taught, but also put it into practice. Toward the end of the series, each group sought out people in their local



community who were in need and set up a practical way to serve them in name of Christ. God led each group to serve many different kinds of people including low-income families, children-at-risk, senior citizens and the homeless. As a result, the Lord not only connected us with individuals but also local organizations who serve these needs on a regular basis. We hope to build partnering “bridges” with them as well. The experience has been such a blessing, we decided to make “serving” in the com-



munity a regular part of every Bridge group session regardless of the topic studied. Therefore, every group will always focus on the Word, prayer, fellowship and *service*.

In the New Year, we are looking forward to studying the faith and practice of the early church in the book of Acts. Praise be to him whose grace extends to us that we might also extend it to others!

## *Discerning [continued from pg. 6]*

On one hand, you might enjoy the genre of a movie such as this and may want to see it with non-churched friends or relatives which *may* lead to an interesting conversation about worldviews, atheism, the abuses of the Church in history and stuff of this nature. It may require you to equip yourself with some basic knowledge of theology, church history or at least to become familiar with some of the criticisms of non-Christians towards the Christian faith. Personally, I absolutely love these kinds of discussions and might want to see this movie with this hope in mind.

On the other hand, perhaps this movie might confuse you or your children or invite a fascinating interest in or attachment to some of the characters and how they view God, the Church or life in general. I recall a student back in college who loved the rock band Pink Floyd so much that he memorized all of their lyrics, dressed like them and even recited their words as if they were the Bible. I hear that others delve into the characters of fantasy games and *Harry Potter* characters to the extent that it disconnects them with reality and life and relationships. In the end, it may not

be worth it to you to expose yourself to movies such as this.

But I’m not comfortable making that call for you. If you’re old enough to see *The Golden Compass* or *I Am Legend* or *Fred Claus*, it may require you to employ that thing called Christian discernment or to ask the Holy Spirit for guidance. If you ask the Lord for these things then I trust that his Spirit will lead you in life and in choosing a good flick to see over the holidays.

Merry Christmas!

## *All Church Christmas Potluck*

Over 350 people came out for a wonderful time on Dec. 8 at the All Church Potluck. Two elves provided an entertaining skit, carols were sung, and everyone enjoyed fellowshiping in the newly refurbished Multi Purpose Room (MPR).



*Evergreen Baptist Church of  
San Gabriel Valley*

323 Workman Mill Road  
La Puente CA 91746-2443

Telephone: 626-363-0300

Fax: 626-363-0301

e-mail: [info@evergreensgv.org](mailto:info@evergreensgv.org)

Website: [www.evergreensgv.org](http://www.evergreensgv.org)

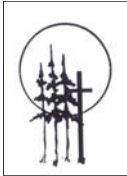

*Senior Pastor  
Cory Ishida*

*Sunday Services*

8:00 & 11:00 am

Church School

9:30 am

Office Hours

Mon-Fri 8:30 am—4:30 pm

## *With Our Greater Community*

### **Haiti Eyeglass Project**

The Cap Haitian Eye Center recycles used eyewear for needy Haitians. Please bring in your donations of eyeglasses you no longer use. This is an ongoing project; whenever enough eyeglasses are received, they are packed up and sent off to Hanford, CA where they are sorted, organized and shipped to Haiti. *Frances Tsuneishi*, a member of our Haiti Task Force has been faithfully serving as EBCSGV's "eyeglass collector" for years. Thanks to those who donate and to *Frances* for managing our project.



### **Saturday Service**

Evergreen SGV sponsors a worship time at Keiro ICF on the second Saturday of each month. A worship team and *Pastor Raynold Nakamura* provide an opportunity for the residents and their families to hear God's word. You are welcome to join them!

Our next worship service will be at 9:45 am Saturday, Jan. 12 at Keiro Intermediate Care Facility, 325 S Boyle Ave, Los Angeles. We will be marking the beginning of a new year with a special program. We'd love to see you there!

### **Volleyball Tournament**

The Japanese Evangelical Missionary Society will have an outreach co-ed volleyball tournament on Saturday, Feb. 16 in Torrance. It is their desire that those attending the tournament will be touched and encouraged to attend local churches. We hope these goals would be accomplished through the guest speaker and the interaction of the players. This tournament will also provide an arena for good fellowship and healthy competition in the sport of volleyball.

Come play, watch and prepare for a great day of competition and fellowship!

Questions? Call JEMS at 213 613-0022 or email [keviny@jems.org](mailto:keviny@jems.org).